

- ① HOUSING MATERIAL: THERMAL PLASTIC, COLOR: BLACK
- ② PHOSPHOR BRONZE
- ③ CONTACT FINISH: .000762[.000030] GOLD MIN IN CONTACT AREA OVER .00127[.000050] MIN NICKEL UNDERPLATE ALL OVER, .00381[.000150] MIN G
- ④ HOLD-DOWN HOLES (2 OR 3 PLACES) $\phi 1.125 \pm 0.025$ [.0453 \pm .0010] DRILL SIZE 0.02-0.08[.001-.003] COPPER PLATING, 0.0076[.0003] MIN 60/40 TIN-LEAD G
- ⑤ NO CENTER HOLD-DOWN
- ⑥ HOT EMBOSS AMP TRADEMARK AND DATE CODE WITH 1.57 ± 0.38 [.062 \pm .015] CHARACTERS AS PART SIZE PERMITS. THE ORDER AND LOCATION IS OPTIONAL.
- ⑦ CONTACT FINISH: .000030 GOLD MIN ON CONTACT AREA, OVER .000050 MIN NICKEL UNDERPLATE ALL OVER .000150 MIN TIN ON SOLDER LEADS .000150 MIN TIN ON HOLD DOWNS.
- ⑧ PRELIMINARY PART

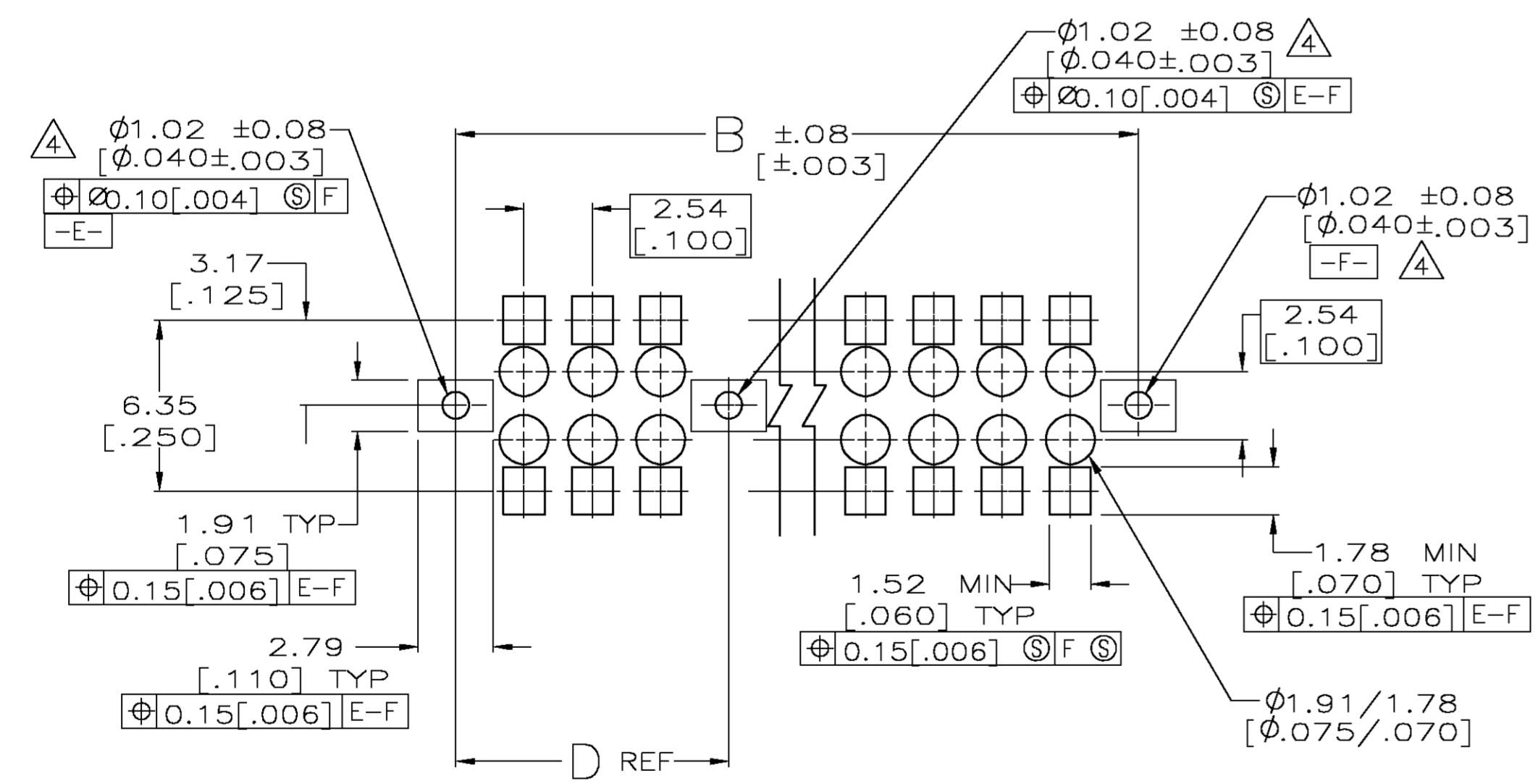
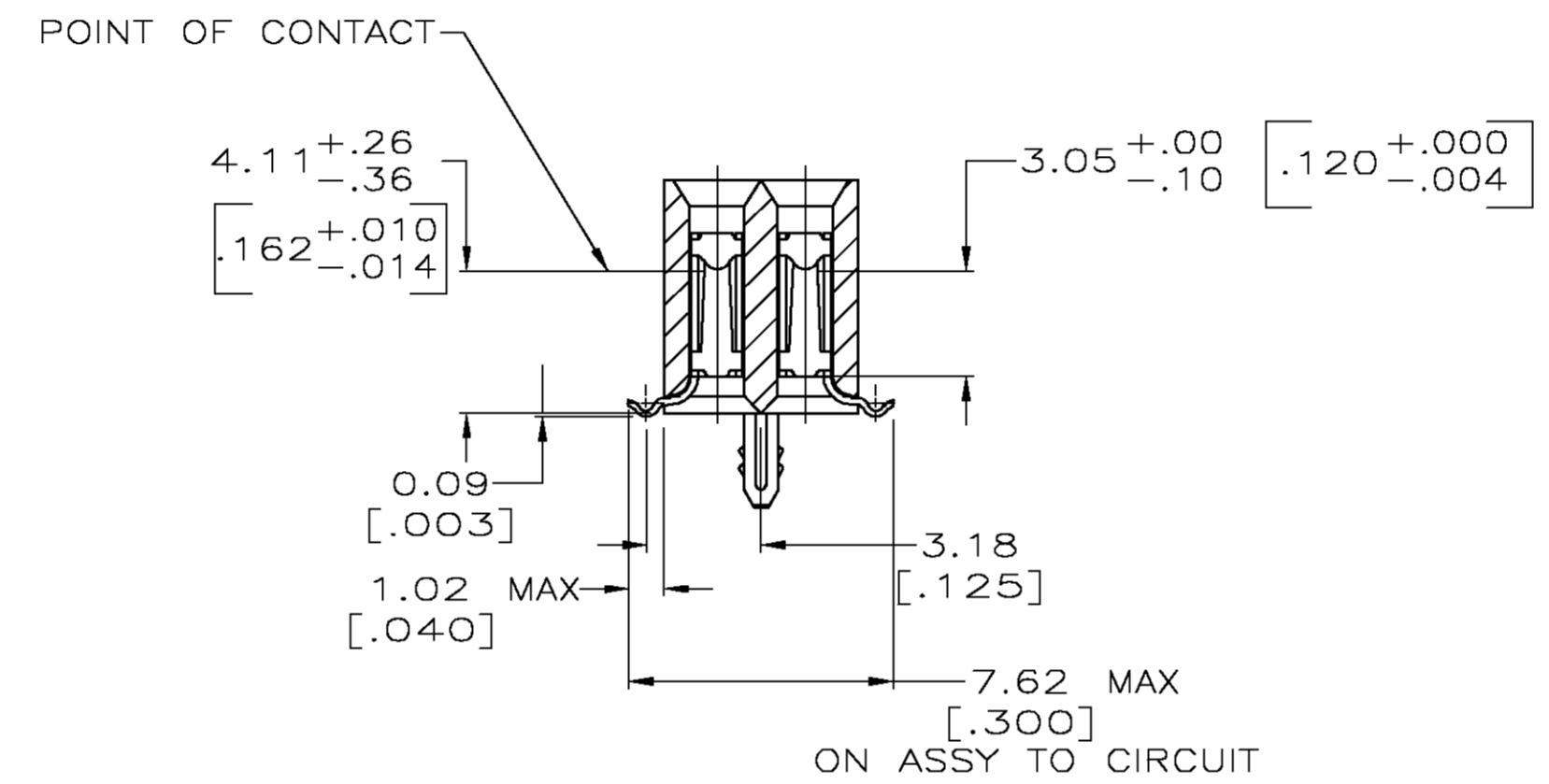
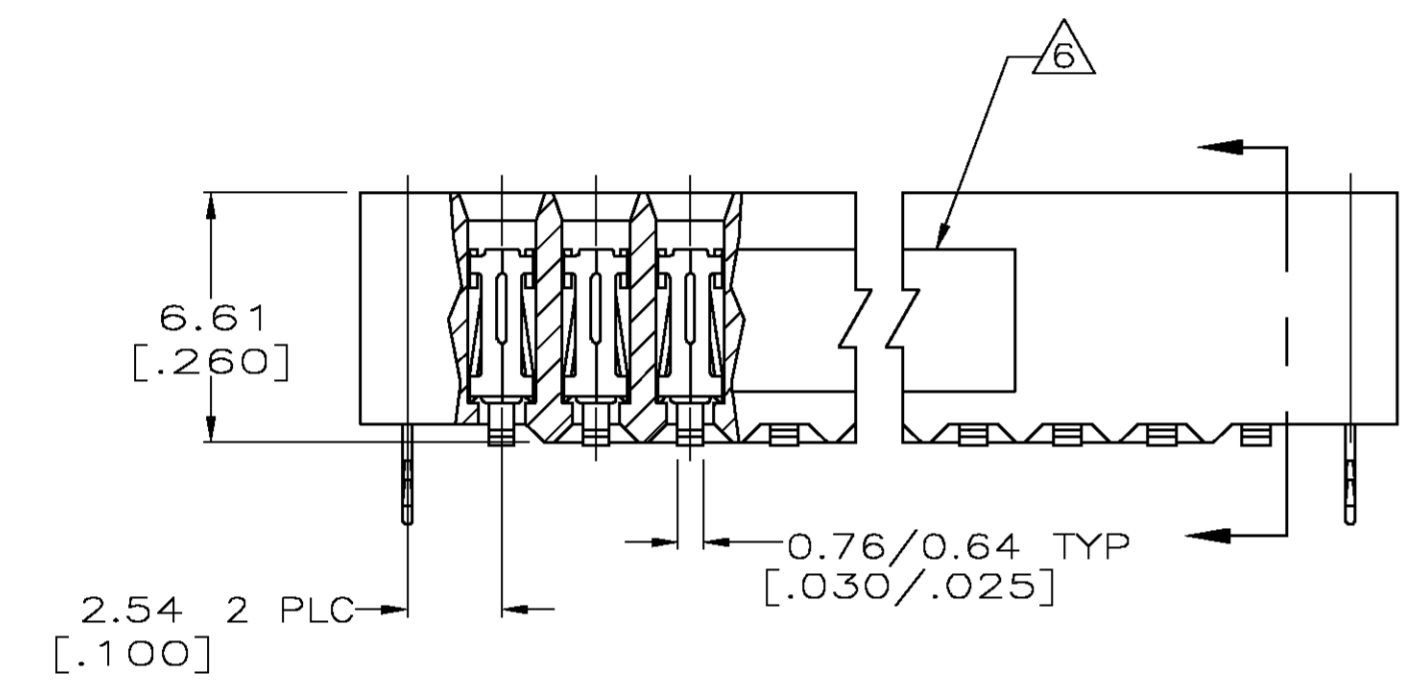
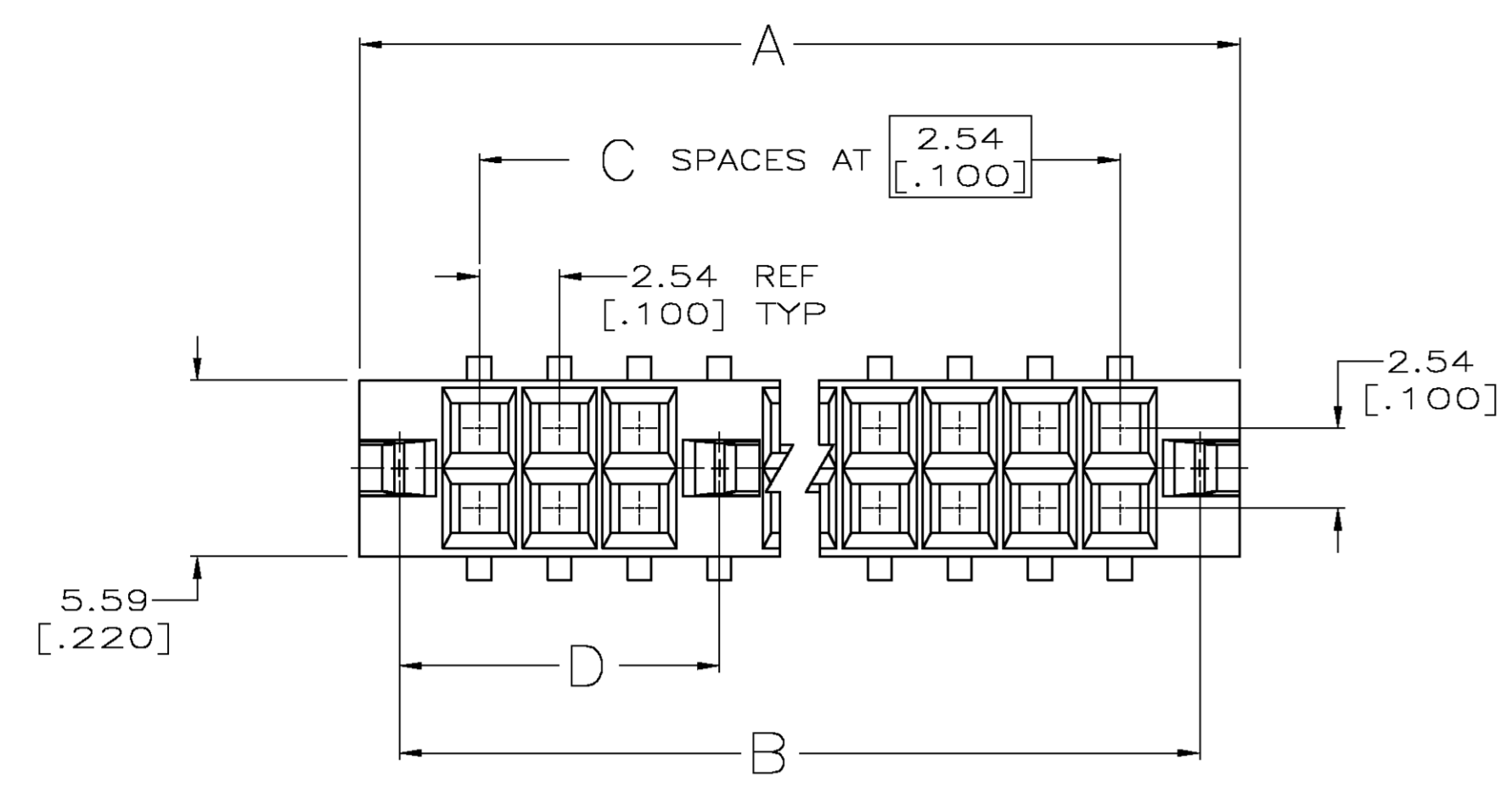

RECOMMENDED ETCHED CIRCUIT LAYOUT
 DIM AND TOL IN ACCORDANCE WITH ANSI-IPC-D-200G, TYPE 1, CLASS C

535959-1 THRU 4-535959-0
 SUPERSEDED BY 147102

FINISH	D	C	B	A	NO OF POSN	PART NUMBER
③	⑤	7	22.86 [1.900]	25.40 [1.000]	16	⑧ 4-535959-1
③	⑤	38	50.80 [2.000]	104.14 [4.100]	78	4-535959-0
③	⑤	37	50.80 [2.000]	101.6 [4.000]	76	3-535959-9
③	⑤	36	48.26 [1.900]	99.06 [3.900]	74	3-535959-8
③	⑤	35	48.26 [1.900]	96.52 [3.800]	72	3-535959-7
③	⑤	34	45.72 [1.800]	93.98 [3.700]	70	3-535959-6
③	⑤	33	45.72 [1.800]	91.44 [3.600]	68	3-535959-5
③	⑤	32	43.18 [1.700]	88.9 [3.500]	66	3-535959-4
③	⑤	30	40.64 [1.600]	86.36 [3.400]	62	3-535959-3
③	⑤	28	38.1 [1.500]	83.82 [3.300]	58	3-535959-2
③	⑤	27	35.56 [1.400]	81.28 [3.200]	56	3-535959-1
③	⑤	26	33.02 [1.300]	78.74 [3.100]	54	3-535959-0
③	⑤	25	30.48 [1.200]	76.2 [3.000]	52	2-535959-9
③	⑤	23	27.94 [1.100]	73.66 [2.900]	48	2-535959-8
③	⑤	22	25.4 [1.000]	71.12 [2.800]	46	2-535959-7
③	⑤	21	22.86 [0.900]	68.58 [2.700]	44	2-535959-6
③	⑤	20	20.32 [0.800]	66.04 [2.600]	42	2-535959-5
③	⑤	18	17.78 [0.700]	63.50 [2.500]	38	2-535959-4
③	⑤	16	15.24 [0.600]	60.96 [2.400]	36	2-535959-3
③	⑤	16	12.7 [0.500]	58.42 [2.300]	34	2-535959-2
③	⑤	15	10.16 [0.400]	55.88 [2.200]	32	2-535959-1
③	⑤	13	7.62 [0.300]	53.34 [2.100]	28	2-535959-0
③	⑤	10	5.08 [0.200]	50.8 [2.000]	22	1-535959-9
③	⑤	8	2.54 [0.100]	48.26 [1.900]	18	1-535959-8
③	⑤	4	1.27 [0.050]	45.72 [1.800]	14	1-535959-7
③	⑤	3	1.016 [0.040]	43.18 [1.700]	8	1-535959-6
③	⑤	2	0.762 [0.030]	40.64 [1.600]	6	1-535959-5
③	⑤	5	1.27 [0.050]	38.1 [1.500]	12	1-535959-2
③	⑤	31	83.82 [3.300]	86.36 [3.400]	64	1-535959-1
③	⑤	11	33.02 [1.300]	35.56 [1.400]	24	1-535959-0
③	⑤	7	22.86 [0.900]	25.40 [1.000]	16	535959-9
③	⑤	40	106.68 [4.200]	109.22 [4.300]	80	535959-8
③	⑤	29	78.74 [3.100]	81.28 [3.200]	60	535959-7
③	⑤	24	66.04 [2.600]	68.58 [2.700]	50	535959-6
③	⑤	19	53.34 [2.100]	55.88 [2.200]	40	535959-5
③	⑤	14	40.64 [1.600]	43.18 [1.700]	30	535959-4
③	⑤	9	27.94 [1.100]	30.48 [1.200]	20	535959-3
③	⑤	12	35.56 [1.400]	38.1 [1.500]	26	535959-2
③	⑤	4	15.24 [0.600]	17.78 [0.700]	10	535959-1

THIS DRAWING IS A CONTROLLED DOCUMENT.

DW	KATE HELM	04/20/90	Tyco Electronics Corporation Harrisburg, Pa
CHK	SAM BEAM	05/02/90	
APVD	RON FELIX	05/02/90	RCPT ASSY, MOD IV, SURFACE-MOUNT BOT-ENTRY, 100CL, WITH BARBED COMPLIANT HOLD-DOWN
PRODUCT SPEC	108-25022		
APPLICATION SPEC	114-25018		RESTRICTED TO
MATERIAL HOUSING:	FINISH CONTACTS: SEE TBL	WEIGHT	A1 00779 535959
CUSTOMER DRAWING		SCALE	5:1
		SHEET	1 OF 1
		REV	V